



Tel: 00213(0)560976666
<http://www.ac-group-industries.com>

LA QUALITÉ REND LA
VIE MEILLEURE

S.A.R.L. Algeria and China Group Industries

Add: Zone Industrielle Essenia2 Classe 1 Ilot 13 Wilaya de Oran Algerie
Contact: 00213(0)561648888 00213(0)561658888
Email: sarl.acgroup@gmail.com



A&C GROUP INDUSTRIES

CATALOGUE

PRESENTATION

La société ALGERIA AND CHINA GROUP INDUSTRIES, créée en 2016, issue d'un partenariat algéro chinois, spécialisée dans la recherche, le développement, la production, la vente et la distribution de différents types de produits de canalisation. Nous assurons nos différents partenaires et clients sur le sérieux et la crédibilité de notre entreprise. En effet notre travail est basé sur le développement continu, l'innovation et la recherche de la perfection en s'appuyant sur les dernières technologies en cours dans le monde. Notre but essentiel est d'assurer une production de qualité supérieure selon la norme internationale iso 9001 .



Mechanical characteristics

When tested in accordance with the test methods as specified in Table 9 using the indicated parameters, the pipe shall withstand the hydrostatic (hoop) stress without bursting. In the case of pipes with (a) barrier layer(s) the test shall be carried out on test pieces produced without the barrier layer(s).

Table 9 — Mechanical characteristics of pipes

Characteristic	Requirement	Joining Secs				Test method
		PP-R				
Resistance to internal pressure	No failure during the test period	Hydrostatic (hoop) stress MPa	Test temp. °C	Test period h	Number of test pieces	EN 921:1994
		16,0	20	1	3	
		4,3	95	22	3	
		3,8	95	165	3	
		3,5	95	1000	3	
Test parameters for all tests						
Sampling procedure				a		
Type of end cap				Type a)		
Orientation of test piece				Not specified		
Type of test				Water-in-water		

Table 10 — Physical and chemical characteristics of pipes

Characteristic	Requirement	Test parameters		Test method
		Parameter	Value	
Longitudinal reversion	≤ 2%	PP-R Duration of exposure for: $e_1 \leq 8\text{mm}$ $8\text{mm} < e_1 \leq 16\text{mm}$ $e_1 > 16\text{mm}$ Number of test pieces	135°C 1h 2h 4h 3	Method B of EN 743:1994 (oven test)
Thermal stability by hydrostatic pressure testing	No bursting during the test period	Sampling procedure Hydrostatic(hoop) stress PP-R Test temperature Type of test End cap Orientation Test period Number of test pieces	1,9 MPa 110°C Water-in-air Type a) Not specified 8760 h 1	EN 921:1994
Impact resistance	< 10%	Sampling procedure Test temperature PP-R Number of test pieces	1) 0°C 10	ISO 9854
Melt flow rate (compound)	≤ 0,5 g/10 min	Test temperature Mass Number of test pieces	230°C 2,16kg 3	ISO 1133
Melt flow rate (pipe)	30% maximum difference compared with compound	Test temperature Mass Number of test pieces	230°C 2,16kg 3	ISO 1133

a the sampling procedure is not specified. For guidance see CEN ISO/TS 15874-7⁴⁾.

Welding Technique

The quality of an installation depends on the tightness, stability and lifetime of its connections. Fusion welding technique is safe because parts made of polypropylene create a homogenous connection, within this process. When the welded joint cools down, it can be fully loaded, the resulting joints are very reliable, and they are as strong as the pipe itself. The pipe may even break before the socket welded joint under tension.

Welding takes only a few seconds. After cutting the pipe perpendicularly to its axis, both the pipes and the fittings (these must be clean if not please clean it with a cloth or alcohol solution) are heated with the welding machine (generally up to 260 °C +/- 10 °C) and they are joined without twisting. For proper connections please follow the table given below.

Pipe Diameter(mm)	Heating Secs	Joining Secs	Cooling time(minutes)
20	5	4	2
25	7	4	3
32	8	6	4
40	12	6	4
50	18	6	5
63	24	8	6
75	30	8	8
90	40	8	8
110	50	10	8

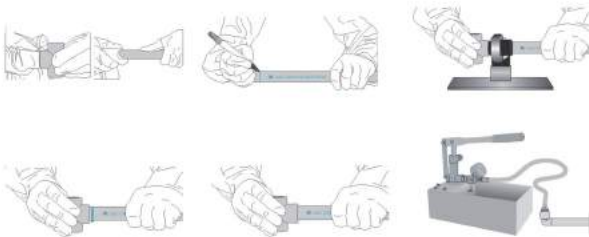

Metal Inserts Used For The Fittings Are BRASS MS 58 Which Means



A&C PP-R Pipes →

أنبوب من عزل الزجاج

Tube fibre de verre en PPR/PN25/S2.5 / PPR GLASS FIBER PIPE/PN25/S2.5



SIZE	CODE
Ø20×3.4	TFV2025
Ø25×4.2	TFV2525
Ø32×5.4	TFV3225
Ø40×6.7	TFV4025
Ø50×8.3	TFV5025
Ø63×10.5	TFV6325
Ø75×12.5	TFV7525
Ø90×15.0	TFV9025
Ø110×18.3	TFV11025

أنبوب من عزل الزجاج

Tube fibre de verre en PPR/PN20/S3.2 / PPR GLASS FIBER PIPE/PN20/S3.2



SIZE	CODE
Ø20×2.8	TFV2020
Ø25×3.5	TFV2520
Ø32×4.4	TFV3220
Ø40×5.5	TFV4020
Ø50×6.9	TFV5020
Ø63×8.6	TFV6320
Ø75×10.3	TFV7520
Ø90×12.3	TFV9020
Ø110×15.1	TFV11020

أنبوب مياه باردة

Tube eau en froide/PN10/S5 / PPR PIPE/TUYAU/PN10/S5



SIZE	CODE
Ø20×2.0	TEF2010
Ø25×2.3	TEF2510
Ø32×2.9	TEF3210
Ø40×3.7	TEF4010
Ø50×4.6	TEF5010
Ø63×5.8	TEF6310

04

أنبوب مياه باردة

Tube eau en froide/PN20/S2.5 / PPRC PIPE/TUYAU/PN20/S2.5



SIZE	CODE C/F
Ø20×3.4	TEC2020
Ø25×4.2	TEC2520
Ø32×5.4	TEC3220
Ø40×6.7	TEC4020
Ø50×8.3	TEC5020
Ø63×10.5	TEC6320
Ø75×12.5	TEC7520
Ø90×15.0	TEC9020
Ø110×18.3	TEC11020

أنبوب مياه باردة

Tube eau en froide/PN16/S3.2 / PPR PIPE/TUYAU/PN16/S3.2



SIZE	CODE
Ø20×2.8	TEF2016
Ø25×3.5	TEF2516
Ø32×4.4	TEF3216
Ø40×5.5	TEF4016
Ø50×6.9	TEF5016
Ø63×8.6	TEF6316
Ø75×10.3	TEF7516
Ø90×12.3	TEF9016
Ø110×15.1	TEF11016

05

أنى منحرف

TE Courbe PPR / PPR TEE CURVE



SIZE	CODE
Ø20	TCB0020
Ø25	TCB0025

أنبوب وصل

Manchon Réduction PPR / PPR REDUCTION SOCKET



SIZE	CODE
Ø25/Ø20	MR2520
Ø32/Ø20	MR3220
Ø32/Ø25	MR3225

قاعدة

Manchon PPR / PPR SOCKET



SIZE	CODE
Ø20	MA0020
Ø25	MA0025
Ø32	MA0032
Ø40	MA0040
Ø50	MA0050
Ø63	MA0063
Ø75	MA0075
Ø90	MA0090
Ø110	MA0110

أنبوب منحرف مؤنث

Tuyaux en courbe PPR / PPR FEMALE CROSSOVER



SIZE	CODE
Ø20	TC0020
Ø25	TC0025
Ø32	TC0032

06

تفصيلة

Réduction PPR / PPR REDUCTION



SIZE CODE

Ø25/Ø20	RE2520
Ø32/Ø20	RE3220
Ø32/Ø25	RE3225
Ø40/Ø20	RE4020
Ø40/Ø25	RE4025
Ø40/Ø32	RE4032
Ø50/Ø20	RE5020
Ø50/Ø25	RE5025
Ø50/Ø32	RE5032
Ø50/Ø40	RE5040
Ø63/Ø20	RE6320
Ø63/Ø25	RE6325
Ø63/Ø32	RE6332
Ø63/Ø40	RE6340
Ø63/Ø50	RE6350
Ø75/Ø20	RE7520
Ø75/Ø25	RE7525
Ø75/Ø32	RE7532
Ø75/Ø40	RE7540
Ø75/Ø50	RE7550
Ø75/Ø63	RE7563
Ø90/Ø40	RE9040
Ø90/Ø50	RE9050
Ø90/Ø63	RE9063
Ø90/Ø75	RE9075
Ø110/Ø32	RE11032
Ø110/Ø40	RE11040
Ø110/Ø50	RE11050
Ø110/Ø63	RE11063
Ø110/Ø75	RE11075
Ø110/Ø90	RE11090

07

كوع براوينة 45 درجة

Coude 45° PPR / PPR ELBOW 45°



SIZE	CODE
Ø20	CO2045
Ø25	CO2545
Ø32	CO3245
Ø40	CO4045
Ø50	CO5045
Ø63	CO6345
Ø75	CO7545
Ø90	CO9045
Ø110	CO11045

كوع براوينة 90 درجة

Coude 90° / PPR ELBOW 90°



SIZE	CODE
Ø20	CO2090
Ø25	CO2590
Ø32	CO3290
Ø40	CO4090
Ø50	CO5090
Ø63	CO6390
Ø75	CO7590
Ø90	CO9090
Ø110	CO11090

حامل البوب

Collier Simple PPR / PPR BRACELET



SIZE	CODE
Ø20	CS0020
Ø25	CS0025
Ø32	CS0032
Ø40	CS0040
Ø50	CS0050

سداد سن مونت

Bouchon PPR / PPR STOPEND

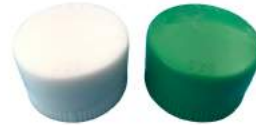

SIZE	CODE
Ø20	BO0020
Ø25	BO0025
Ø32	BO0032
Ø40	BO0040
Ø50	BO0050
Ø63	BO0063
Ø75	BO0075
Ø90	BO0090
Ø110	BO0110

حامل البوب الثنائي

Collier double PPR / PPR DOUBLE BRACELET



SIZE	CODE
Ø20	CD0020
Ø25	CD0025
Ø32	CD0032

حامل البوب مغلقة الثنية

Collier A CLIC simple PPR / PPR BRACELET WITH COVER



SIZE	CODE
Ø16	CCS0016
Ø20	CCS0020
Ø25	CCS0025
Ø32	CCS0032

حامل البوب الثنائي مغلقة الثنية

Collier A CLIC double PPR / PPR DOUBLE BRACELET WITH COVER



SIZE	CODE
Ø16	CCD0016
Ø20	CCD0020
Ø25	CCD0025

تي غير متساوية

Te Inegal PPR / PPR INEGALE TEE



SIZE	CODE
Ø25/Ø20/Ø25	TI2520
Ø32/Ø20/Ø32	TI3220
Ø32/Ø25/Ø32	TI3225
Ø40/Ø20/Ø40	TI4020
Ø40/Ø25/Ø40	TI4025
Ø40/Ø32/Ø40	TI4032
Ø50/Ø20/Ø50	TI5020
Ø50/Ø25/Ø50	TI5025
Ø50/Ø32/Ø50	TI5032
Ø50/Ø40/Ø50	TI5040
Ø63/Ø20/Ø63	TI6320
Ø63/Ø25/Ø63	TI6325
Ø63/Ø32/Ø63	TI6332
Ø63/Ø40/Ø63	TI6340
Ø63/Ø50/Ø63	TI6350
Ø75/Ø20/Ø75	TI7520
Ø75/Ø25/Ø75	TI7525
Ø75/Ø32/Ø75	TI7532
Ø75/Ø40/Ø75	TI7540
Ø75/Ø50/Ø75	TI7550
Ø75/Ø63/Ø75	TI7563
Ø90/Ø40/Ø90	TI9040
Ø90/Ø50/Ø90	TI9050
Ø90/Ø63/Ø90	TI9063
Ø90/Ø75/Ø90	TI9075
Ø110/32/Ø110	TI11032
Ø110/40/Ø110	TI11040
Ø110/50/Ø110	TI11050
Ø110/63/Ø110	TI11063
Ø110/75/Ø110	TI11075
Ø110/90/Ø110	TI11090

لكرة وصل بين مونث

Mamelon femelle en PPR / PPR FEMALE NIPPLE



SIZE	CODE
Ø20*½"	MF2015
Ø20*¾"	MF2020
Ø25*½"	MF2515
Ø25*¾"	MF2520
Ø32*½"	MF3215
Ø32*¾"	MF3220
Ø32*1"	MF3225
Ø40*1*1/4"	MF4032
Ø50*1½"	MF5040
Ø63*2"	MF6350
Ø75*2 ½"	MF7563
Ø90*3"	MF9075
Ø110*4"	MF11090

لكرة وصل بين مذكر

Mamelon mâle en PPR / PPR MALE ELBOW



SIZE	CODE
Ø20*½"	MM2015
Ø20*¾"	MM2020
Ø25*½"	MM2515
Ø25*¾"	MM2520
Ø32*½"	MM3215
Ø32*¾"	MM3220
Ø32*1"	MM3225
Ø40*1*1/4"	MM4032
Ø50*1½"	MM5040
Ø63*2"	MM6350
Ø75*2½"	MM7563
Ø90*3"	MM9075
Ø110*4"	MM11090

مسخن صنوبر

Vanne de radiateurs Mamelon / VALVE OF RADIATORS



SIZE	CODE
Ø20*½"	VRM2015
Ø25*¾"	VRC2520

مسخن صنوبر

Vanne de radiateurs Coude / VALVE OF RADIATORS ELBOW



SIZE	CODE
Ø20*½"	VRC2015
Ø25*¾"	VRC2520

صنوبر مدور

Vanne sphérique / PPR PLASTIC BALL VALVE



SIZE	CODE
Ø20	VS0020
Ø25	VS0025
Ø32	VS0032
Ø40	VS0040
Ø50	VS0050
Ø63	VS0063
Ø75	VS0075
Ø90	VS0090
Ø110	VS0110

كوع نقصان

Coude Réduction PPR / PPR 90°REDUCTION ELBOW



SIZE	CODE
Ø25/Ø20	CR2520
Ø32/Ø25	CR3225

12

كوع بسن نكر 90 درجة

Coude mâle en PPR 90° / PPR 90°MALE ELBOW



SIZE	CODE
Ø20*½"	CM2015
Ø20*¾"	CM2020
Ø25*½"	CM2515
Ø25*¾"	CM2520
Ø32*½"	CM3215
Ø32*¾"	CM3220
Ø32*1"	CM3225

تي

Te PPR / PPR TEE



SIZE	CODE
Ø20	TE0020
Ø25	TE0025
Ø32	TE0032
Ø40	TE0040
Ø50	TE0050
Ø63	TE0063
Ø75	TE0075
Ø90	TE0090
Ø110	TE0110

كوع بسن مؤنث 90 درجة

Coude femelle en PPR 90° / PPR 90°FEMALE ELBOW



SIZE	CODE
Ø20*½"	CF2015
Ø20*¾"	CF2020
Ø25*½"	CF2515
Ø25*¾"	CF2520
Ø32*½"	CF3215
Ø32*¾"	CF3220
Ø32*1"	CF3225

13

أكورة وصل متحركة بسن مونت

Mamelon avec Raccord / PPR NIPPE WITH PLASTIC LOOSE NUT



SIZE	CODE
Ø20*½"	MAR2015
Ø20*¾"	MAR2020
Ø25*¾"	MAR2520
Ø32*1"	MAR3225

كوع متحرك بسن مونت

Coude avec Raccord / PPR ELBOW WITH PLASTIC LOOSE NUT



SIZE	CODE
Ø20*½"	CAR2015
Ø20*¾"	CAR2020
Ø25*¾"	CAR2520
Ø32*1"	CAR3225

تي بسن مونت

TE femelle en PPR / PPR FEMALE TEE



SIZE	CODE
Ø20*½"	TF2015
Ø20*¾"	TF2020
Ø25*½"	TF2515
Ø25*¾"	TF2520
Ø32*½"	TF3215
Ø32*¾"	TF3220
Ø32*1"	TF3225
Ø40*½"	TF4015
Ø40*¾"	TF4020
Ø40*1"	TF4025
Ø40*1*1/4"	TF4032
Ø50*½"	TF5015
Ø50*¾"	TF5020
Ø50*1"	TF5025
Ø63*½"	TF6315
Ø63*¾"	TF6320
Ø63*1"	TF6325

تي متحرك بسن مونت

TE avec Raccord / PPR TEE WITH PLASTIC LOOSE NUT



SIZE	CODE
Ø20*½"	TAR2015
Ø20*¾"	TAR2020
Ø25*¾"	TAR2520
Ø32*1"	TAR3225

تي بسن منكر

TE mâle en PPR / PPR MALE TEE



SIZE	CODE
Ø20*½"	TM2015
Ø20*¾"	TM2020
Ø25*½"	TM2515
Ø25*¾"	TM2520
Ø32*½"	TM3215
Ø32*¾"	TM3220
Ø32*1"	TM3225
Ø40*1*1/4"	TM4032

قاعدة خلاط ثابت مع كوع مونت خارجي

Applique double fix femelle apparent / PPR DOUBLE BATTERY CONNECTION FEMALE APPARENT



SIZE	CODE
20*½"	ADFA2015
20*¾"	ADFA2020

قاعدة خلاط ثابت مع كوع منكر خارجي

Applique double fix mâle apparent / PPR DOUBLE BATTERY CONNECTION MALE APPARENT



SIZE	CODE
20*½"	ADMA2015
20*¾"	ADMA2020

قاعدة خلاط ثابت مع كوع مونت داخلي

Applique double fix femelle encastrée / PPR DOUBLE BATTERY CONNECTION FEMALE



SIZE	CODE
Ø20*½"	ADFE2015
Ø20*¾"	ADFE2020
Ø25*½"	ADFE2515
Ø25*¾"	ADFE2520

قاعدة خلاط ثابت مع كوع مترك داخلي

Applique double fix mâle encastrée / PPR DOUBLE BATTERY CONNECTION MALE



SIZE	CODE
Ø20*½"	ADMA2015
Ø20*¾"	ADMA2020
Ø25*½"	ADMA2515
Ø25*¾"	ADMA2520

محول أنثى

Raccord union femelle en PPR / PPR TRANSITION UNION FEMALE



SIZE	CODE
Ø20*½"	RUF2015
Ø25*¾"	RUF2520
Ø32*1"	RUF3225
Ø40*1*1/4"	RUF4032
Ø50*1½"	RUF5040
Ø63*2"	RUF6350
Ø75*2½"	RUF7563
Ø90*3"	RUF9075
Ø110*4"	RUF11090

محول ذكر

Raccord union mâle en PPR / PPR TRANSITION UNION MALE



SIZE	CODE
Ø20*½"	RUM2015
Ø25*¾"	RUM2520
Ø32*1"	RUM3225
Ø40*1*1/4"	RUM4032
Ø50*1½"	RUM5040
Ø63*2"	RUM6350
Ø75*2½"	RUM7563
Ø90*3"	RUM9075
Ø110*4"	RUM11090

محول من البلاستيك

Raccord union plastique / PPR PLASTIC TRANSITION



SIZE	CODE
Ø20	RUP0020
Ø25	RUP0025
Ø32	RUP0032
Ø40	RUP0040
Ø50	RUP0050
Ø63	RUP0063

سدادة بين ذكر

Bouchon Filletée / PPR STOPEND



SIZE	CODE
Ø20*½"	BF2015
Ø25*¾"	BF2520

كوع بين مونث بربط بالحايط

Applique femelle en PPR 90° / PPR 90° FEMALE BATTERY



SIZE

Ø20*½"	AF2015
Ø20*¾"	AF2020
Ø25*½"	AF2515
Ø25*¾"	AF2520

كوع بين منكر بربط بالحايط

Applique mâle en PPR 90° / PPR 90° MALE BATTERY



SIZE

Ø20*½"	AM2015
Ø20*¾"	AM2020
Ø25*½"	AM2515
Ø25*¾"	AM2520

أكرة وصل للحمامات و الصونة من البلاستيك

Mamelon de piquage plastique / SADDLE NIPPLE PLASTIC



SIZE

CODE

Ø20*½"	MPP2015
Ø25*¾"	MPP2520

أكرة وصل للحمامات و الصونة بين مونث

Mamelon de piquage femelle / SADDLE NIPPLE FEMALE



SIZE

CODE

Ø20*½"	MPF2015
Ø25*¾"	MPF2520

Ces produits existent en couleur blanche et Verte

أكرة وصل للحمامات و الصونة بين منكر

Mamelon de piquage mâle / SADDLE NIPPLE MALE



SIZE

CODE

Ø20*½"	MPM2015
Ø25*¾"	MPM2520

داعم

Calles Pour Poteau en beton



SIZE

CODE

Ø25/06-12	CPP25/06-12
-----------	-------------

داعم أرضي

Calles Pour Semelle en beton



SIZE

CODE

Ø25/08-24	CP525/08-24
-----------	-------------

لداة مكنية للحام خاصة

Matrice de piquage / PINCH WELDING APPAT



SIZE

CODE

Ø50/20-25	MP502025
-----------	----------

أداة مكينة اللحام

Matrice PPR / PPR WELDING APARAT



SIZE	CODE
Ø20	MAT0020
Ø25	MAT0025
Ø32	MAT0032
Ø40	MAT0040
Ø50	MAT0050
Ø63	MAT0063
Ø75	MAT0075
Ø90	MAT0090
Ø110	MAT0110

أداة مكينة اللحام للتصليح

Matrice de Reparation / WELDING APARAT TO REPAIR



SIZE	CODE
6mm	MDR6

جهاز لاختبار التسريبات

Appareil à tester fuites / WELDING TO DETECT FLIGHT



CODE
ATF0000

مكينة اللحام

Appareil A fusion / PIPE WELDING SUITCASE



SIZE	CODE
Ø20-63	APF2063
Ø75-110	APF75110

مقص الأنبوب

Ciseau / PIPE CUTTER



SIZE	CODE
Ø3-42	CIS1642

مقص الأنبوب

Ciseau / PIPE CUTTER



SIZE	CODE
Ø20-75	CIS20-75

مقص الأنبوب

Ciseau / PIPE CUTTER



SIZE	CODE
Ø14-65	CIS14-65
Ø32-110	CIS32-110